

Daily Inspection of Electrical Protection Gloves

Proper field inspection requires visual inspection of the electrical insulating gloves inside and outside.

Ansell

1

Grasp glove.

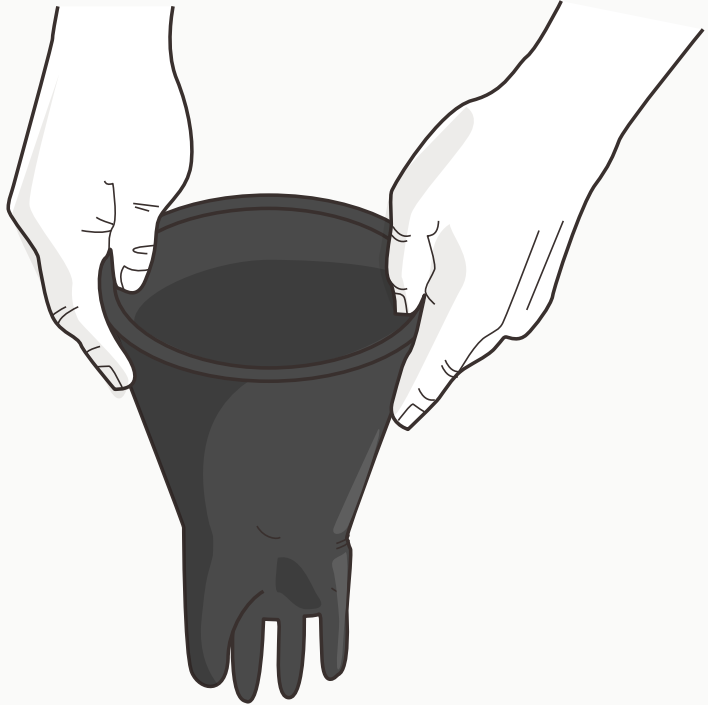

2

Stretch to seal closed.

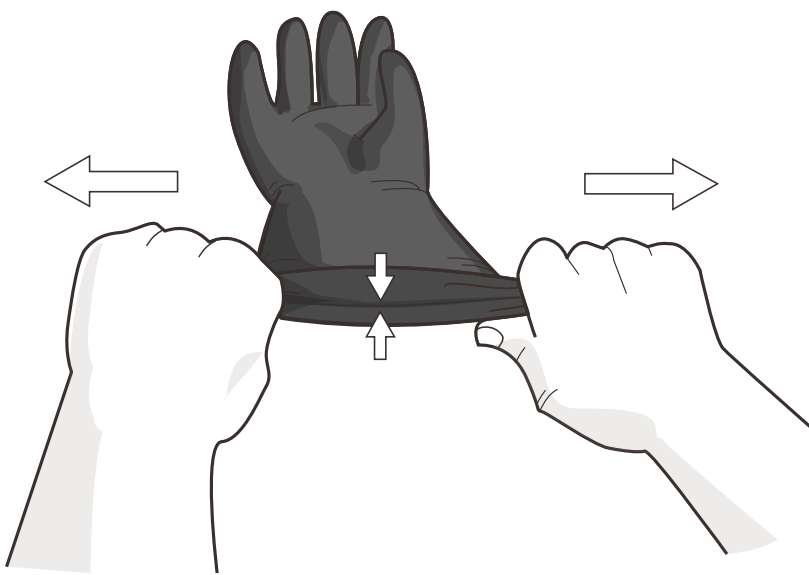

3

Press and roll tightly.



4

Twirl glove, rotating on rolled ends.



5

Entrap air by holding in one hand.

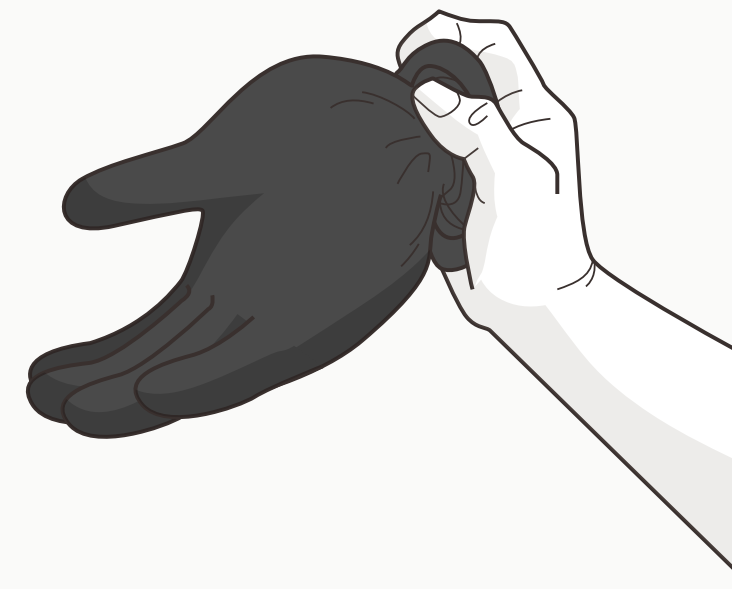

6

Hold close to ear, squeeze to add pressure, listen and feel for pinhole leaks.



7

Check for the most recent test date.
Register the issue date of the glove.

Most recent test date

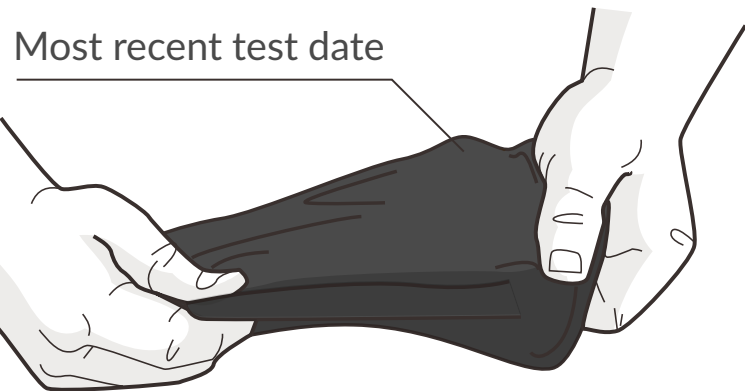

8

Turn glove inside out and repeat process.



9

In leather protectors, look for any oil, grease or cut or abrasion or other foreign substances that could disqualify the glove for energized service use.

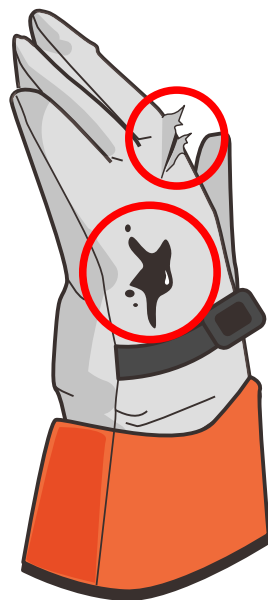

10

When donning and doffing the gloves, it is imperative that you are not wearing and have removed all jewelry and watches.

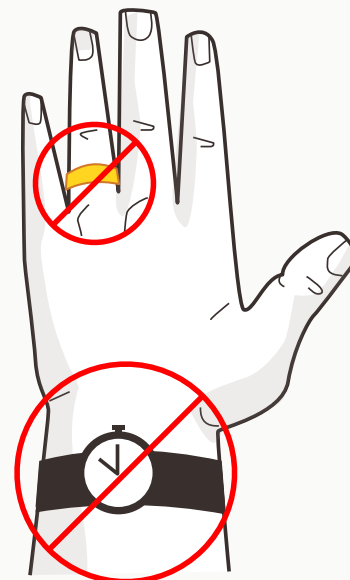

11

Do not stretch the protector.

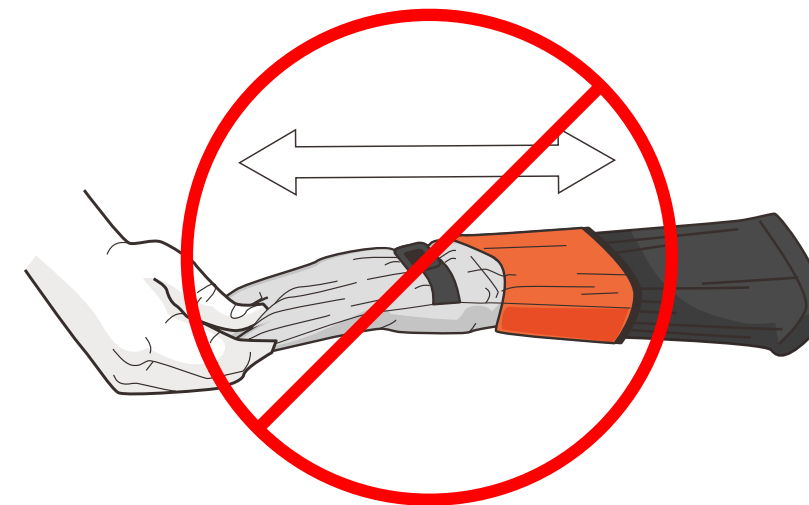

12

Use caution and remove the protectors carefully to guard against damaging the integrity of the gloves.

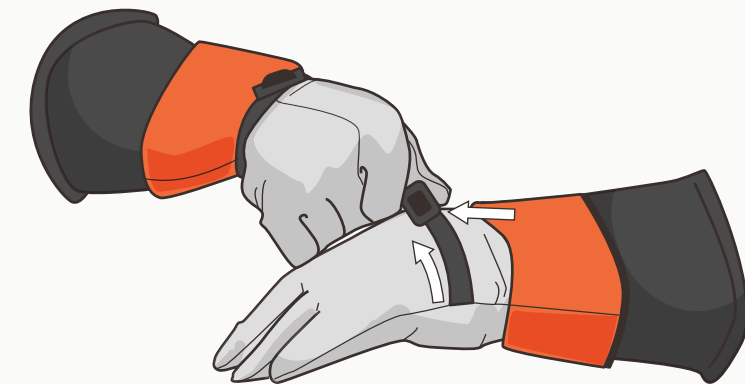

ACTIVARMR®

Remember:

Selecting the proper class of gloves for the voltage being worked on, verifying the gloves, having recent lab testing and ensuring the gloves are free of defects by rigorous daily field inspection are critical steps to preventing electrical accidents and saving lives.

www.ansell.com